



Bondi Junction, NSW

206/3 Gray Street

1 1 1
BED BATH CAR

Bond | Opulent 1-Bedroom + Study Residence

Situated within the coveted BOND development, proudly presenting an elegantly appointed 1-bedroom plus study residence, achieving new heights for a luxurious, low-maintenance lifestyle. Perched on the corner of the second floor, the apartment is designed by the award-winning Koichi Takada Architects. Residents of BOND enjoy exclusive access to the rooftop terrace with multiple barbecues, sun lounges, picnic tables, fire pits, grass space, and a movie screen, perfect for unwinding at the end of a busy day.

Occupying an iconic position, convenient to Westfield Bondi Junction, Eastgate Shopping Centre, Bronte Road eateries, and Bondi Junction Railway Station. The new Bondi Junction RSL will occupy the ground floor too!

Key features:

? Light-filled open-plan living and dining area, seamlessly opening through stacker doors to an impressive, partially undercover, entertainers' terrace, ideal for alfresco dining.

? The luxurious kitchen showcasing quality Meile stainless steel appliances, including gas cooktop, under-bench oven and integrated dishwasher, complemented by an abundance of storage throughout, and elegant stone benchtops and splash back.

Application Accepted

Type: Apartment

Date Available: 06/05/2024

<https://www.mintlifestyle.com.au>



Brett Phillips

0414 887 266

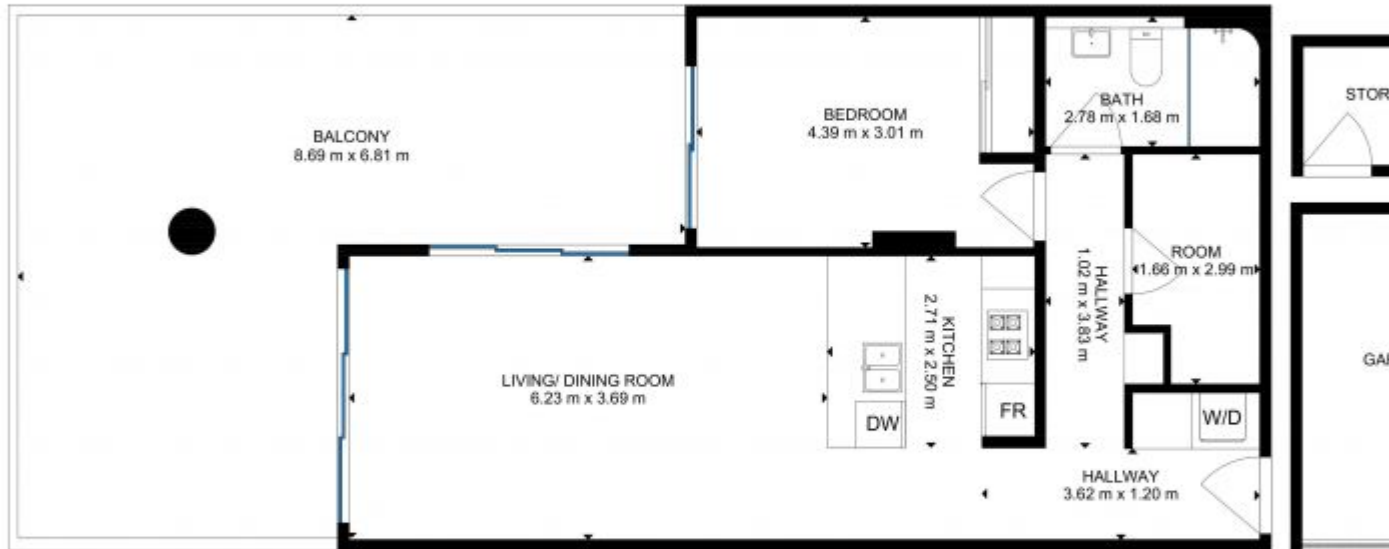

Plans shown are only indicative of layout. Dimensions are approximate.

Bondi Junction, NSW
206/3 Gray Street